

Corporate Party Friday, February 17th 120 guests (6:30p-10:30p)

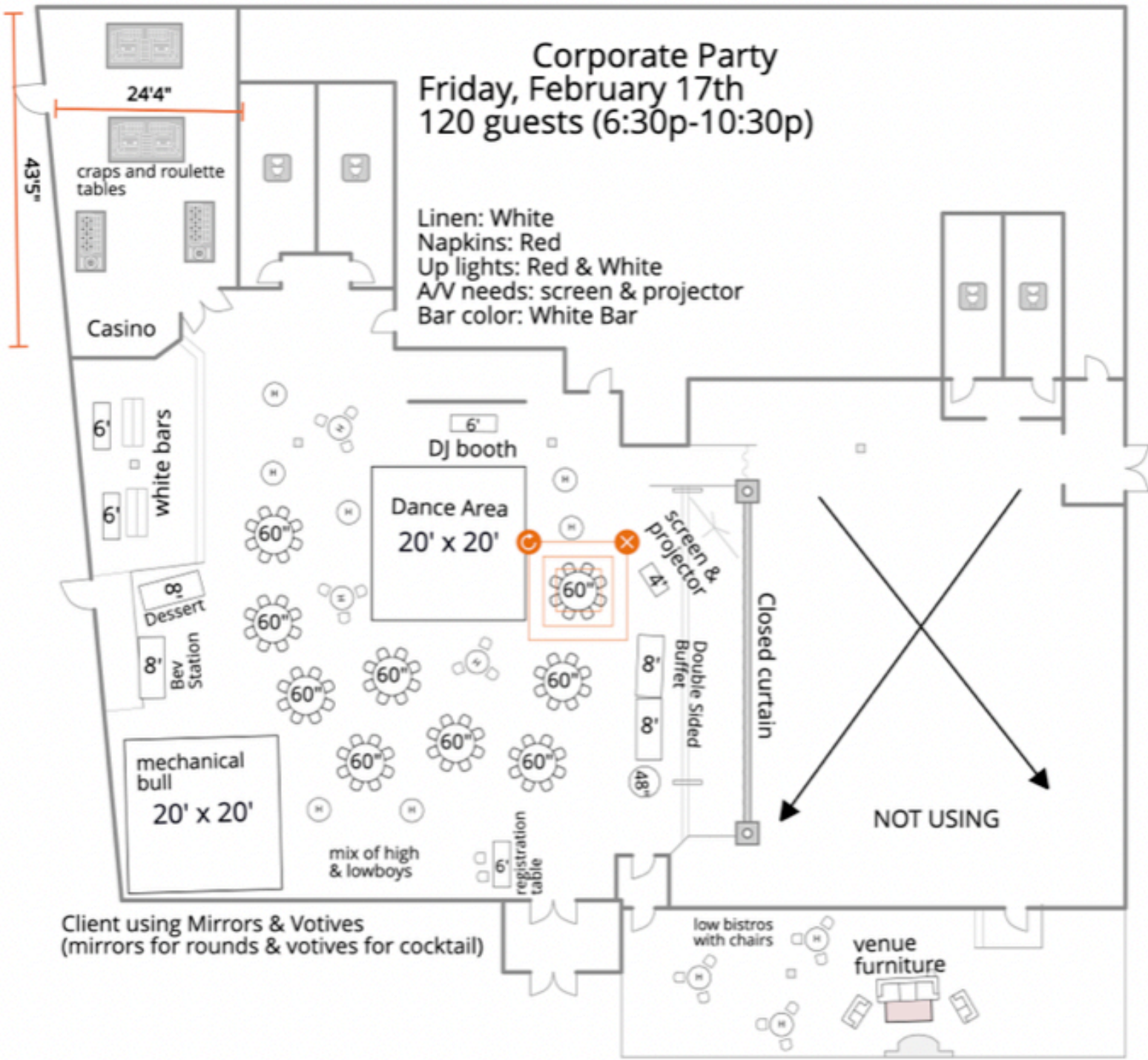

Linen: White
Napkins: Red
Up lights: Red & White
A/V needs: screen & projector
Bar color: White Bar

Client using Mirrors & Votives
(mirrors for rounds & votives for cocktail)

NOT USING

Holiday Party
Sunday, November 20th
120 guests 7p-11p

Kids Room

Napkin:
Linen:
Bar Color:
DOC:

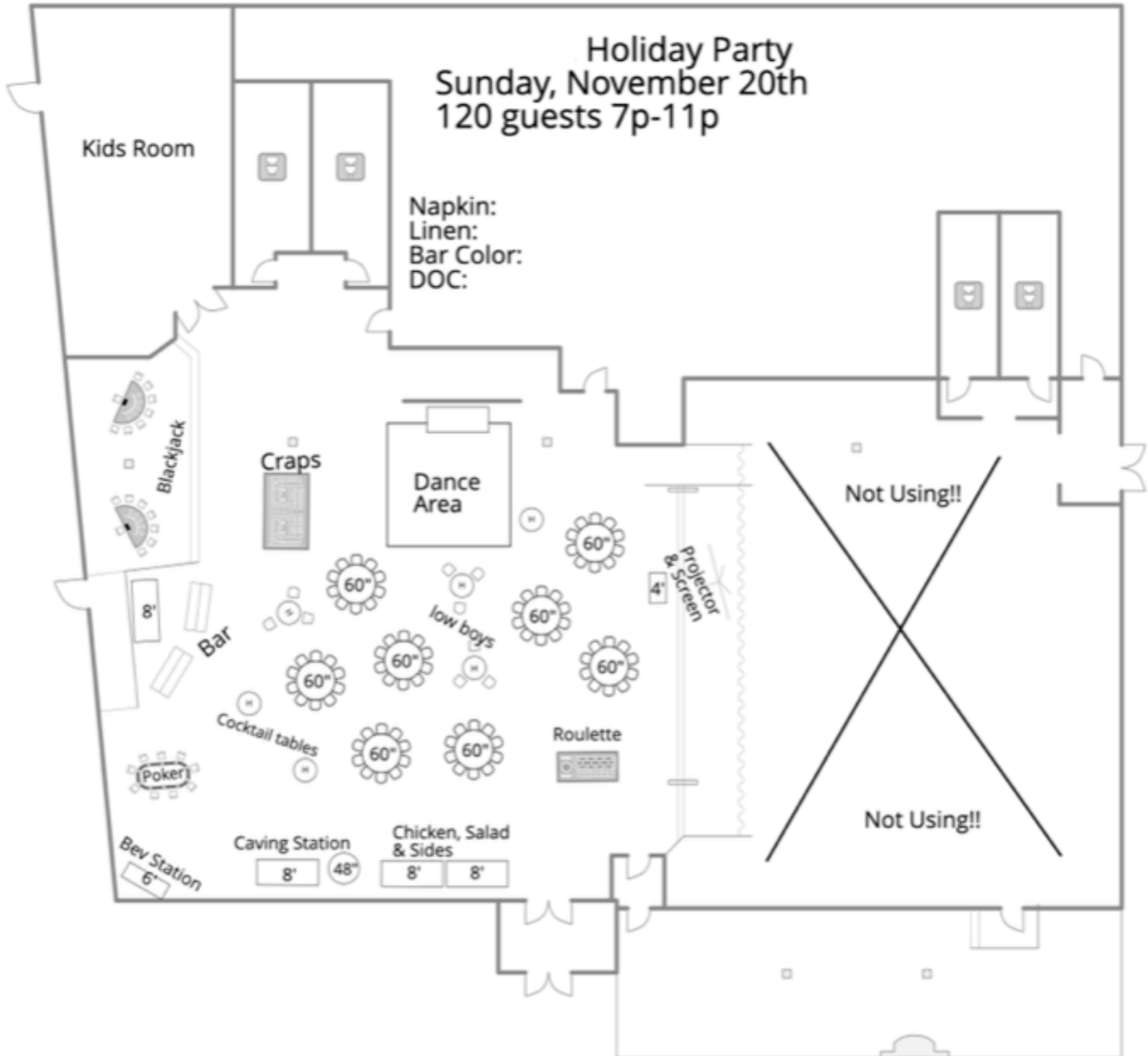

Holiday Party

Thursday, Dec 8th
140 guests 7p-11p

Linen: Navy Blue
Napkin: Light Blue
Uplights: Blue
DOC: Anabel

(5) bistros with 4 chairs = 24 seats
(15) 60" rounds w/ 8 chairs = 120 seats
144 seats total

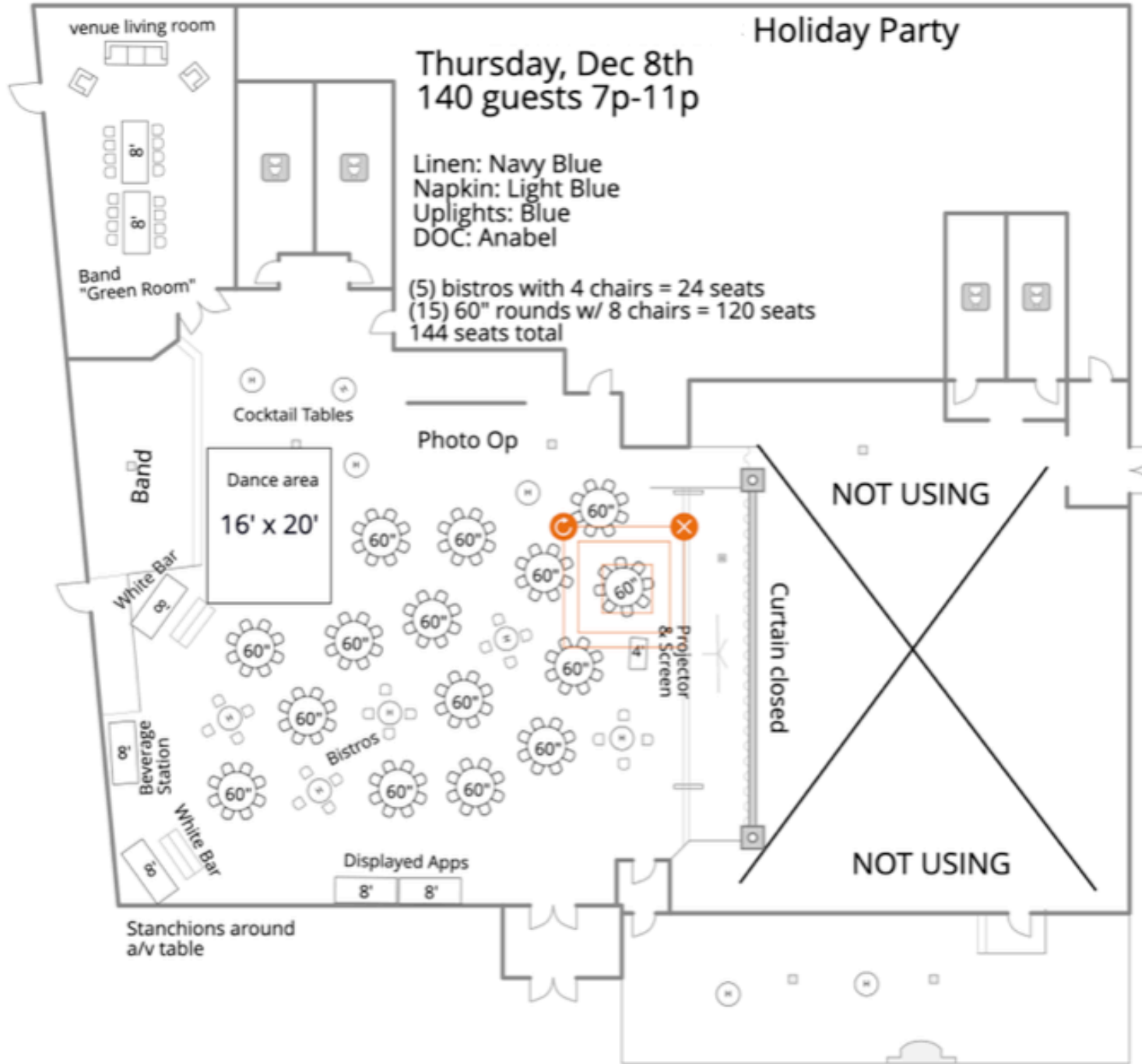

venue living room

Band "Green Room"

Band

White Bar

Beverage Station

White Bar

Dance area
16' x 20'

Cocktail Tables

Photo Op

Projector & Screen

Curtain closed

NOT USING

NOT USING

Displayed Apps
8' 8'

Stanchions around
a/v table

8'
8'

60"

60"

60"

60"

60"

60"

60"

60"

60"

60"

60"

60"

60"

60"

60"

60"

Bistros

Holiday Party

Friday, December 9
80 guests 7pm-11pm

Linen: White
Napkins: Royal Blue
Uplights: Alternating Light blue & Dark blue
Mirrors on Table with Silver Votives
Fireplace on

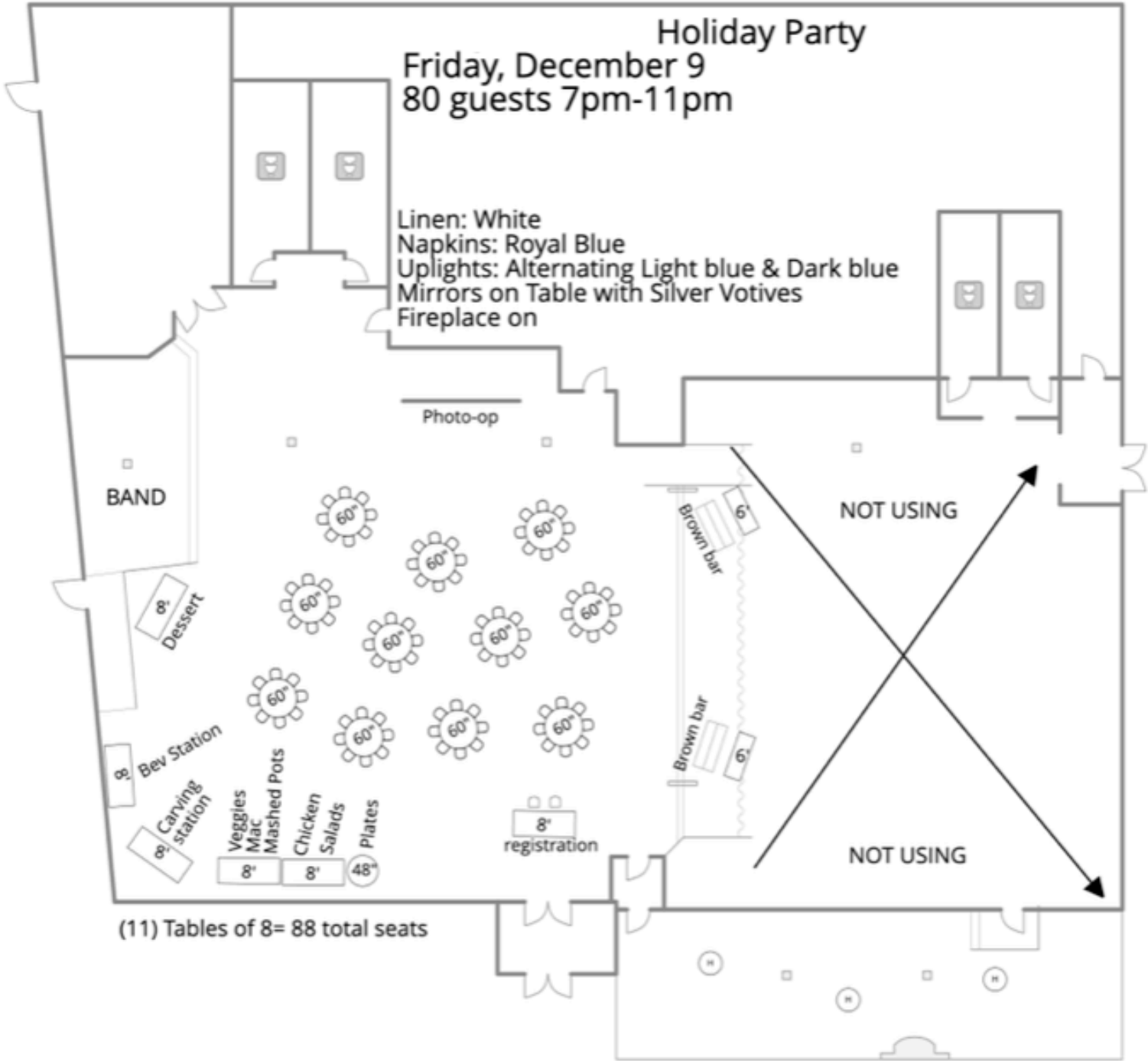

(11) Tables of 8= 88 total seats

Thursday, Dec 15th
Holiday Party
160 guests (6:30p-9:30p)

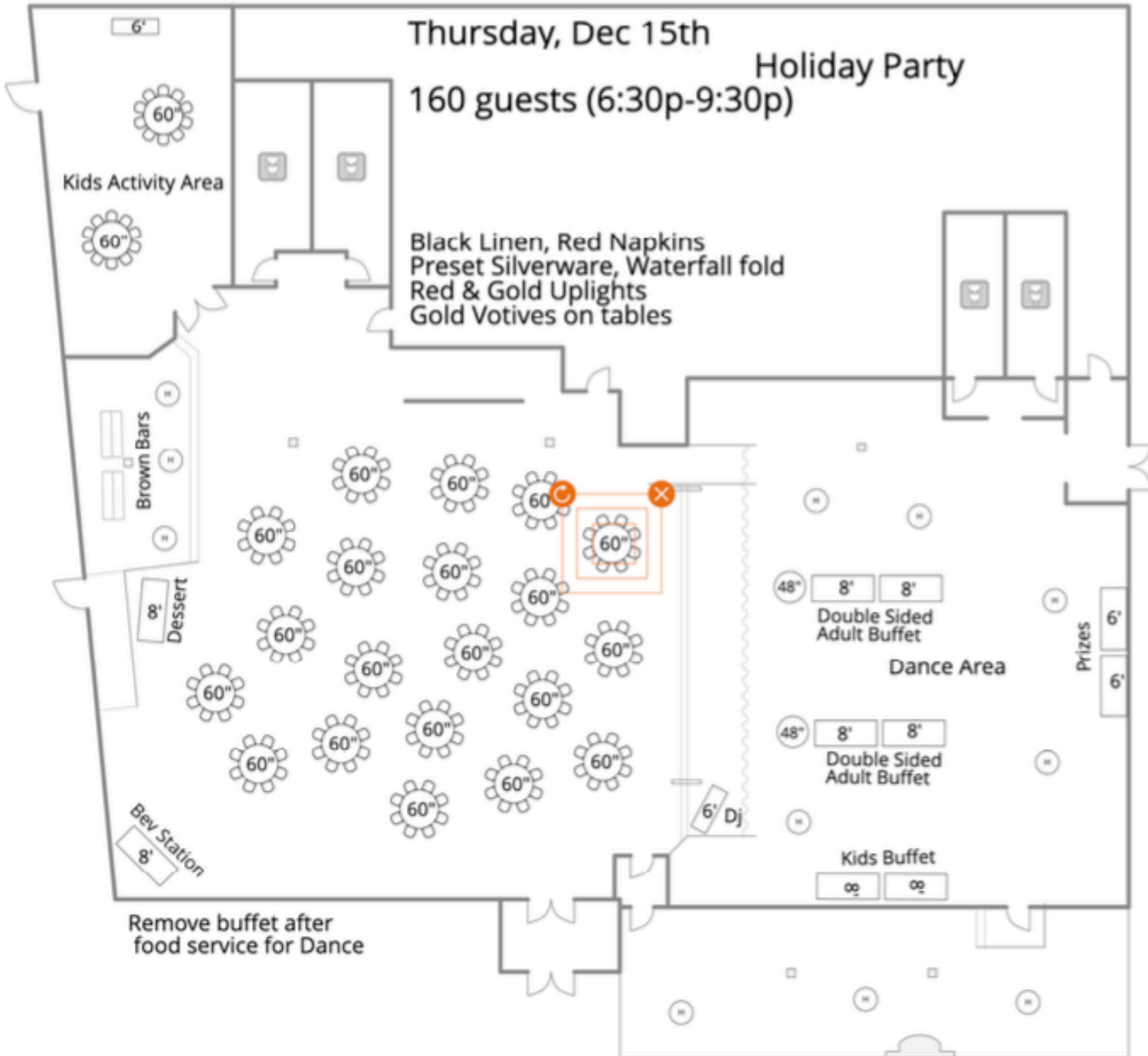

Remove buffet after food service for Dance

Monday, December 12
Christmas Party
6p-8p (40 guests)

Linen: Black
Napkin: Red & Green
Uplights: Red & Green

****PRESET WATER & SILVERWARE****

NOT USING

NOT USING

8' bev station
Brown Bars

projector & Screen

venue speaker

8' Brisket
veggies
mashed pots

8' Salad
Chicken

48" plates

48" grazing board

registration

6'

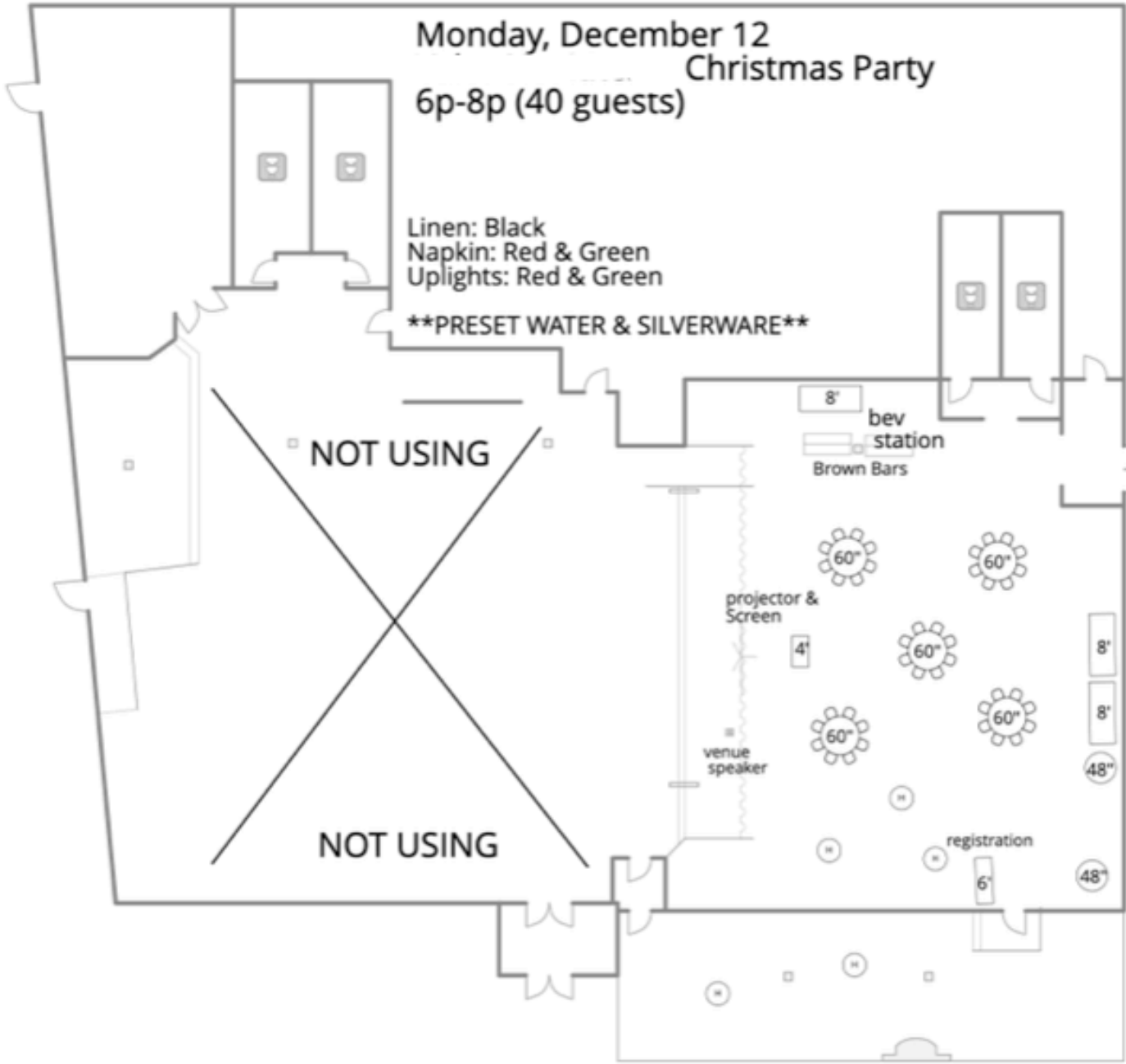

Christmas Party
Friday, December 16th
140 guests 7:00pm-11:00pm

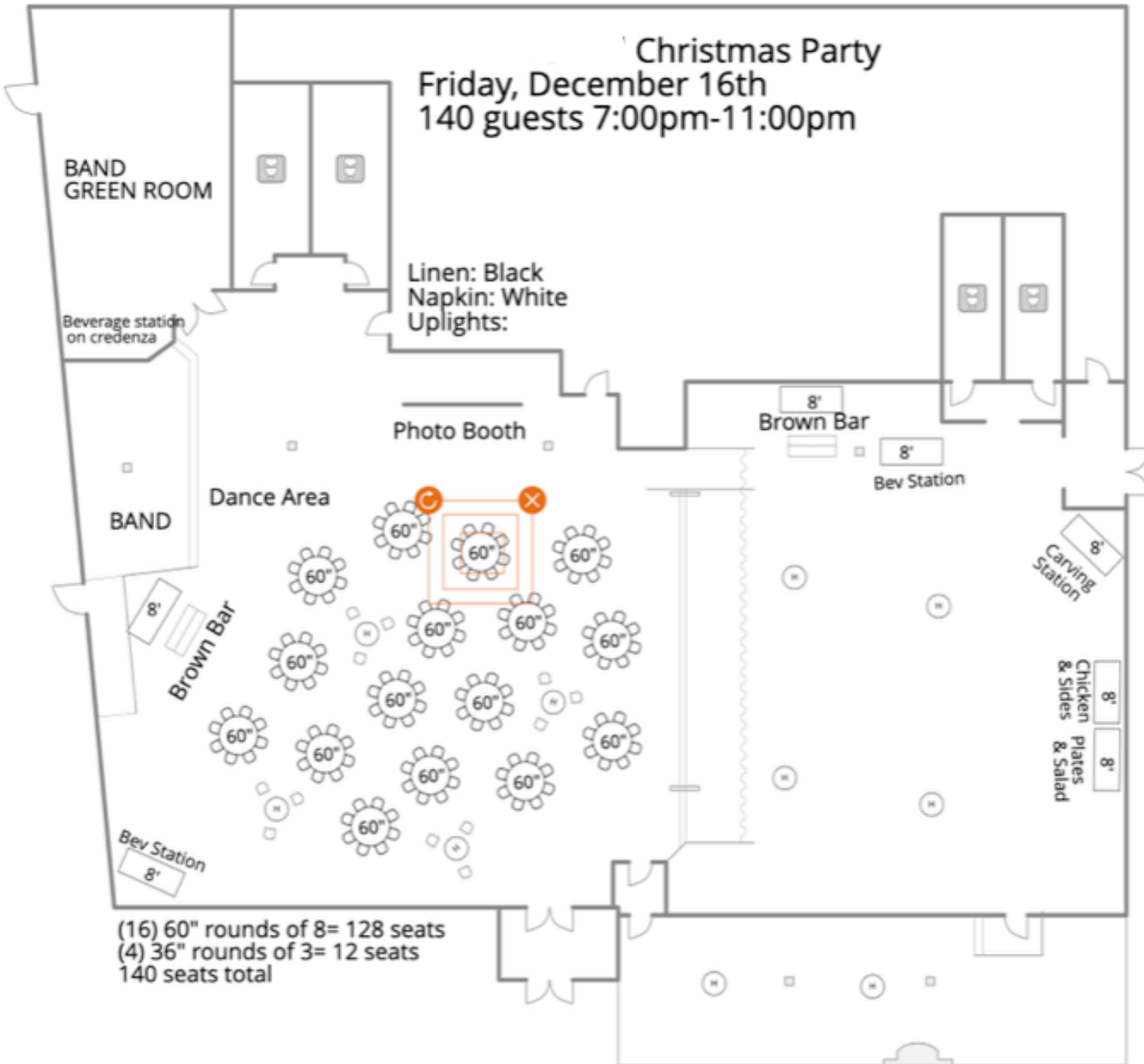

(16) 60" rounds of 8= 128 seats
(4) 36" rounds of 3= 12 seats
140 seats total

Saturday, December 10
Holiday Party
100 guests 7p-12a

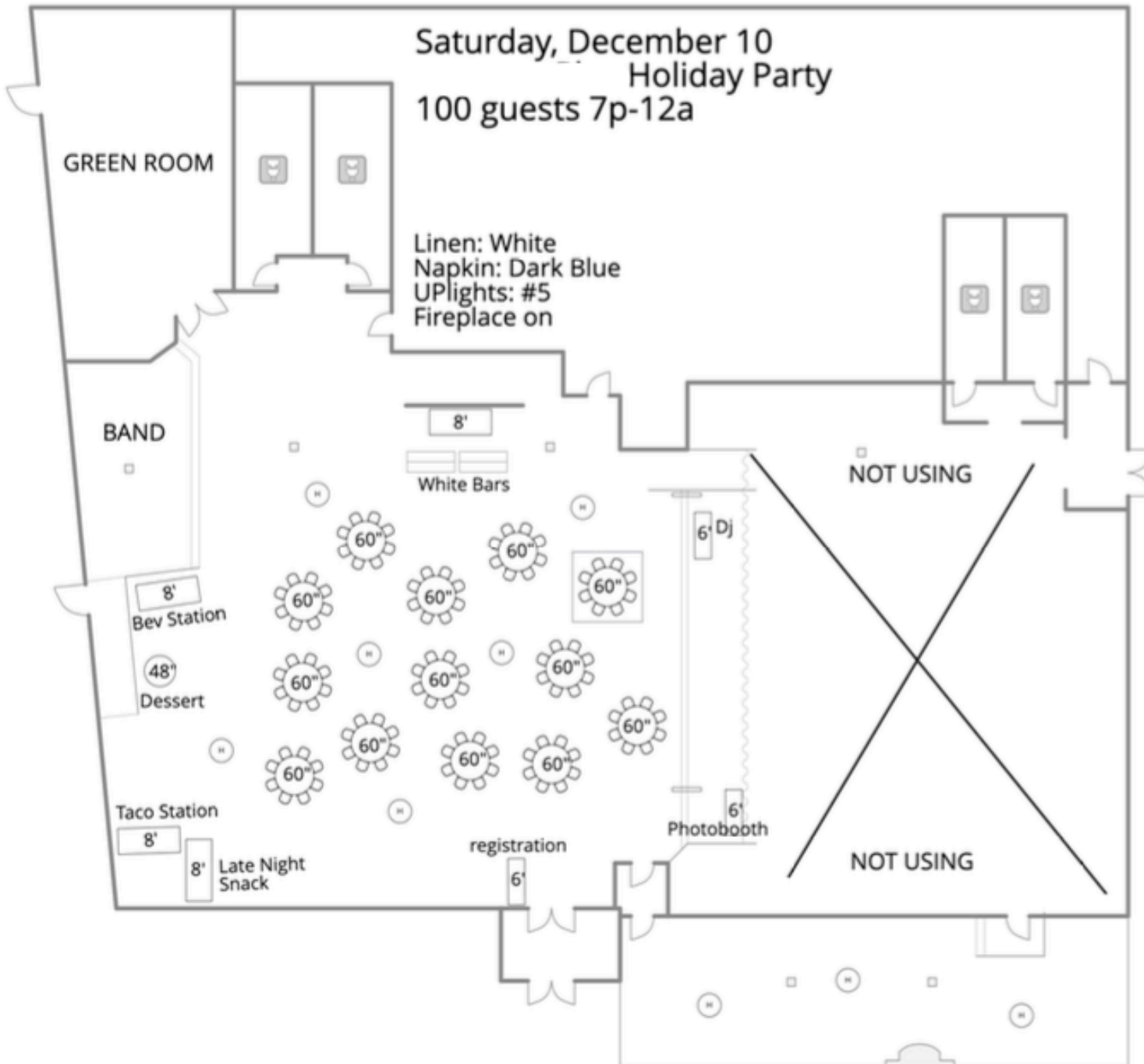

Wednesday, December 7th
Holiday Party
100 guests 4:30pm- 7:30 pm

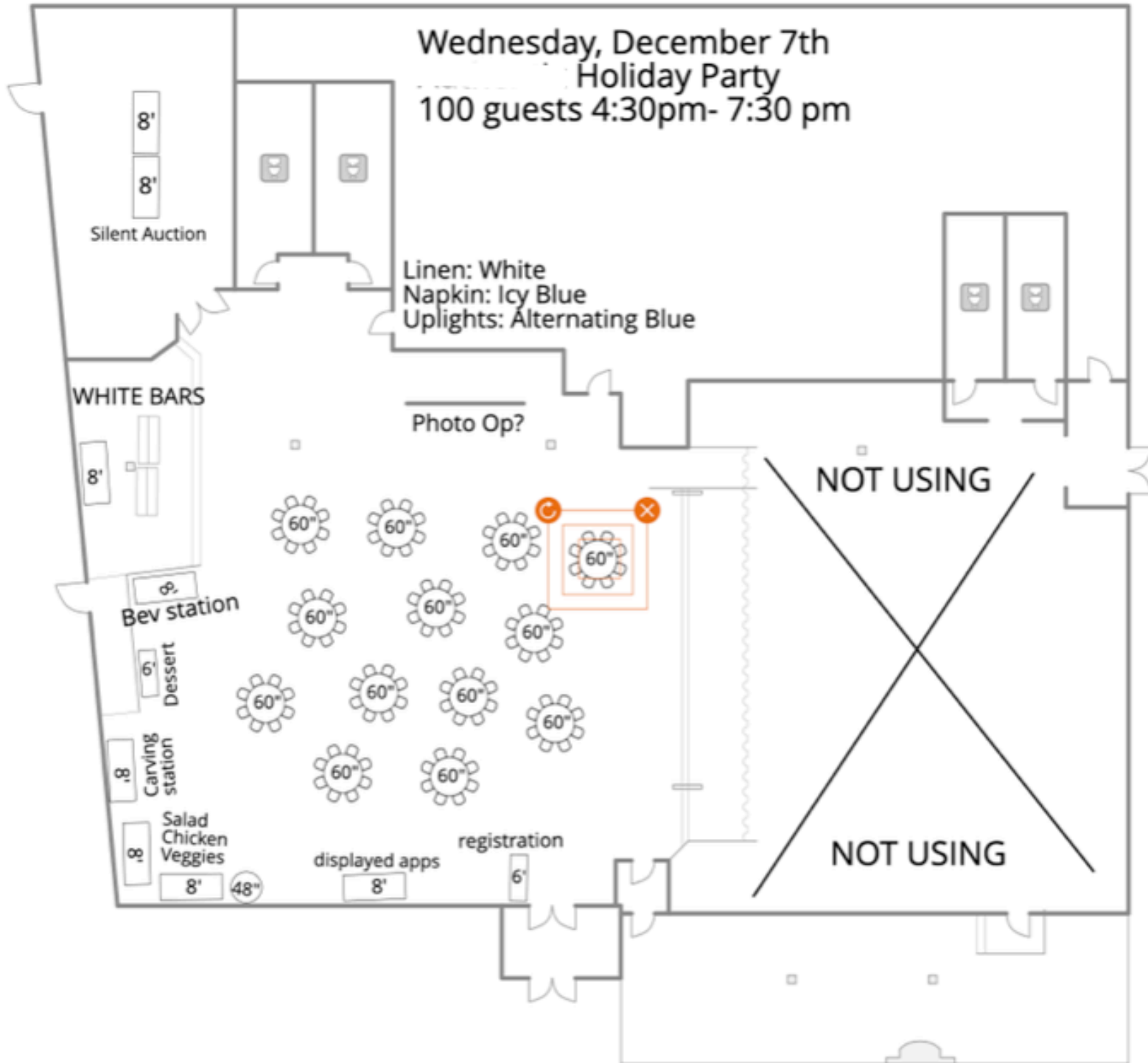

Silent Auction

Linen: White
Napkin: Icy Blue
Uplights: Alternating Blue

WHITE BARS

Photo Op?

NOT USING

Bev station

Dessert

Carving station

Salad
Chicken
Veggies

displayed apps

registration

NOT USING

Holiday Party Friday, December 1st 350 Guests

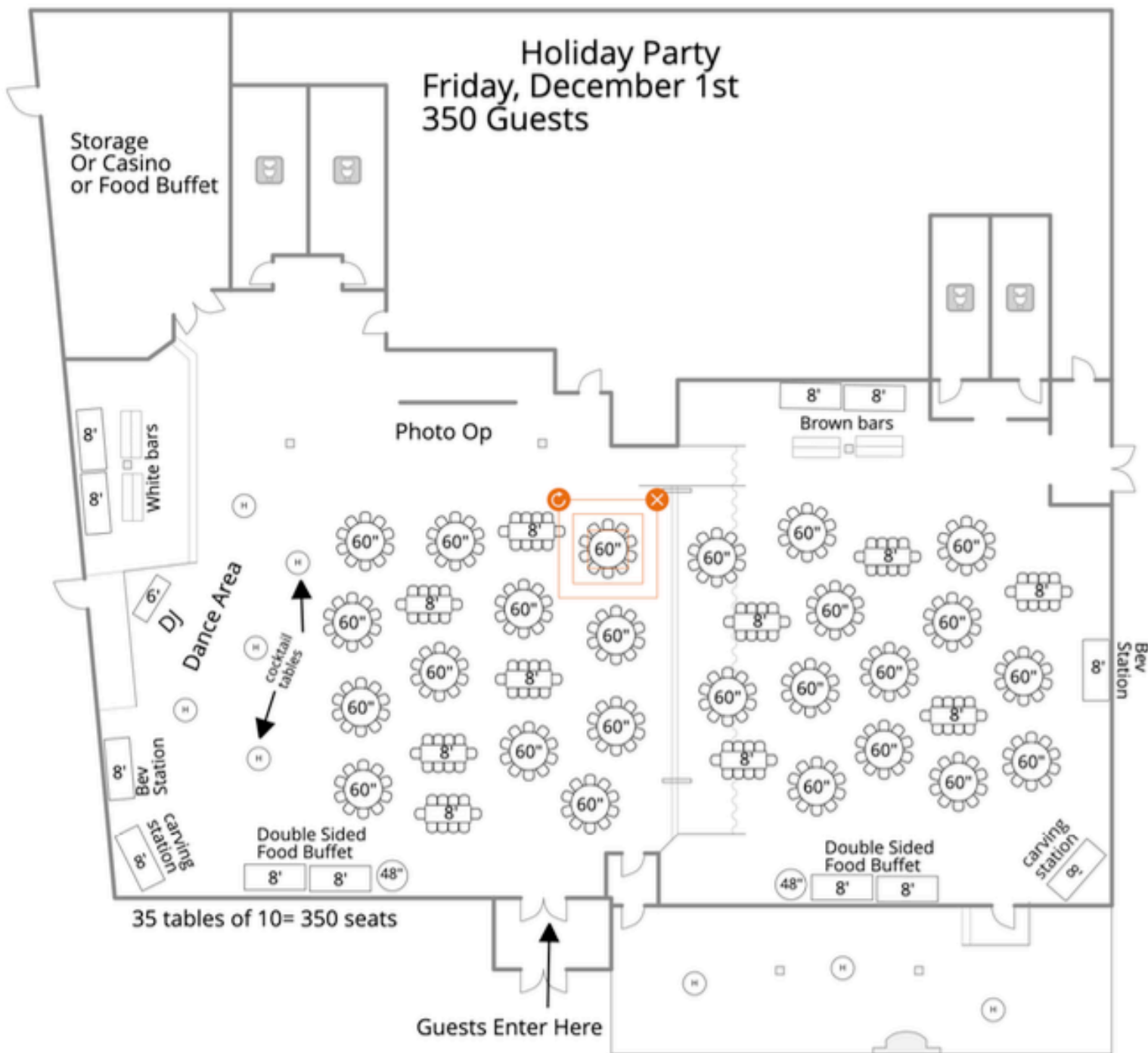

Thursday, December 1st
Christmas Party
125 guests 6:30p-9:30p

Linen: Black
Napkin: Apple Red & Kelly Green (waterfall)
Uplights: Red & Green alternating
Venue Mirrors & Votives

****PRESET WATER, NAPKIN & SILVERWARE****

