

# Mitzvah

Saturday, February 18th 2023  
125 guests (7p-11p)

Storage

Linen: White  
Napkins: Fuchsia & Gold  
(waterfall for adults, rollups for teens)

Uplights: Pink & Gold  
Planner: Peta

Teens Sitting Area



projector & screen

Dance Area  
20' x 20'

Venue Couch

Tator Tots  
Macaroni

Burritos  
Waffles

Teen Food  
plates & silver  
White Bar

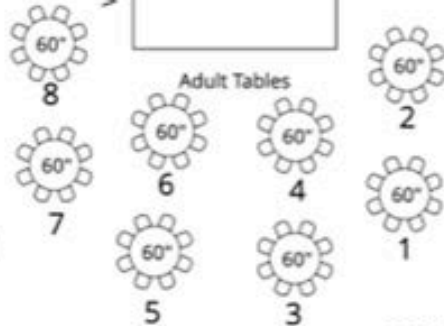

Photobooth

Fat Straws  
Sweat Shirts

escort cards

Sign in table

Curtains closed during cocktail for adults

Brown Bars  
Back2Back

Salad

Salmon

Wok Station

Plates

Highboys

Far East Display

Adult Tables= 8 tables of 8  
Kids Tables= 6 tables of 6

Teens Enter Here

Adults Enter Here

Mitzvah  
Saturday, April 22  
150 Guests 7p-11p

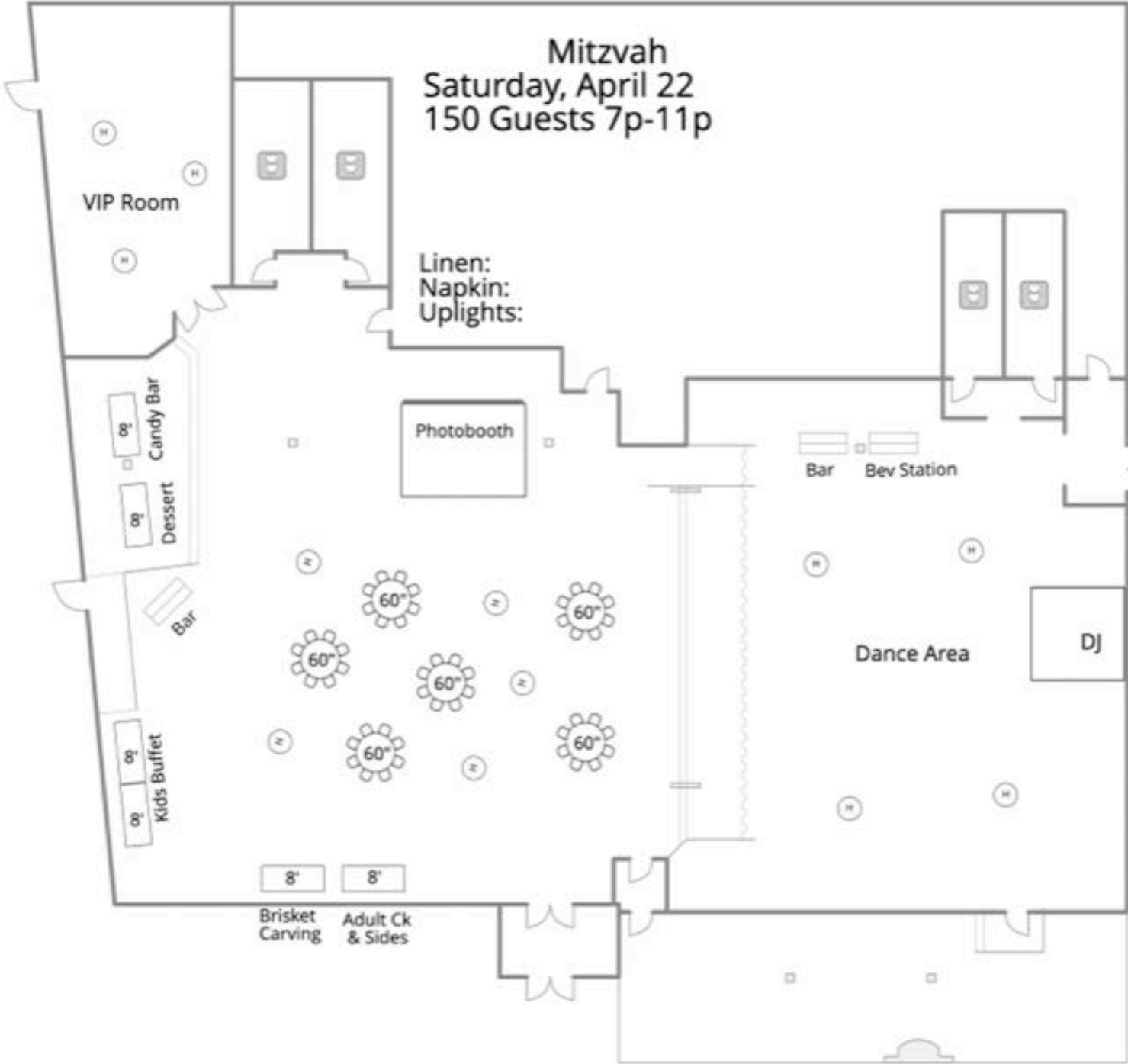

Mitzvah  
 Saturday, April 15 2023  
 125k/61a (6:30p-11:00p)

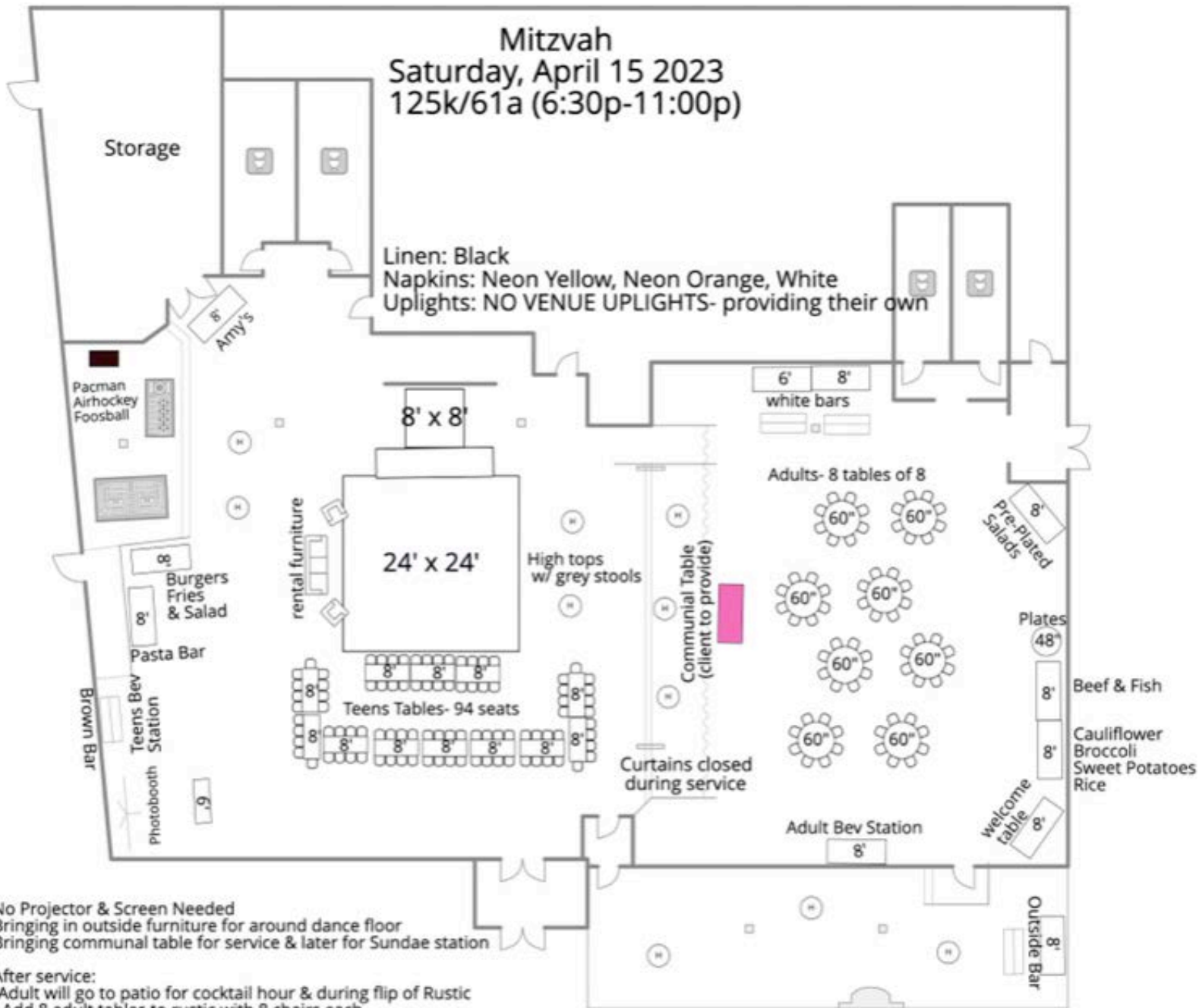

No Projector & Screen Needed  
 Bringing in outside furniture for around dance floor  
 Bringing communal table for service & later for Sundae station

After service:  
 -Adult will go to patio for cocktail hour & during flip of Rustic  
 - Add 8 adult tables to rustic with 8 chairs each

Saturday, May 13, 2023  
Mitzvah  
120 guests (90A, 30K) 7p-11p

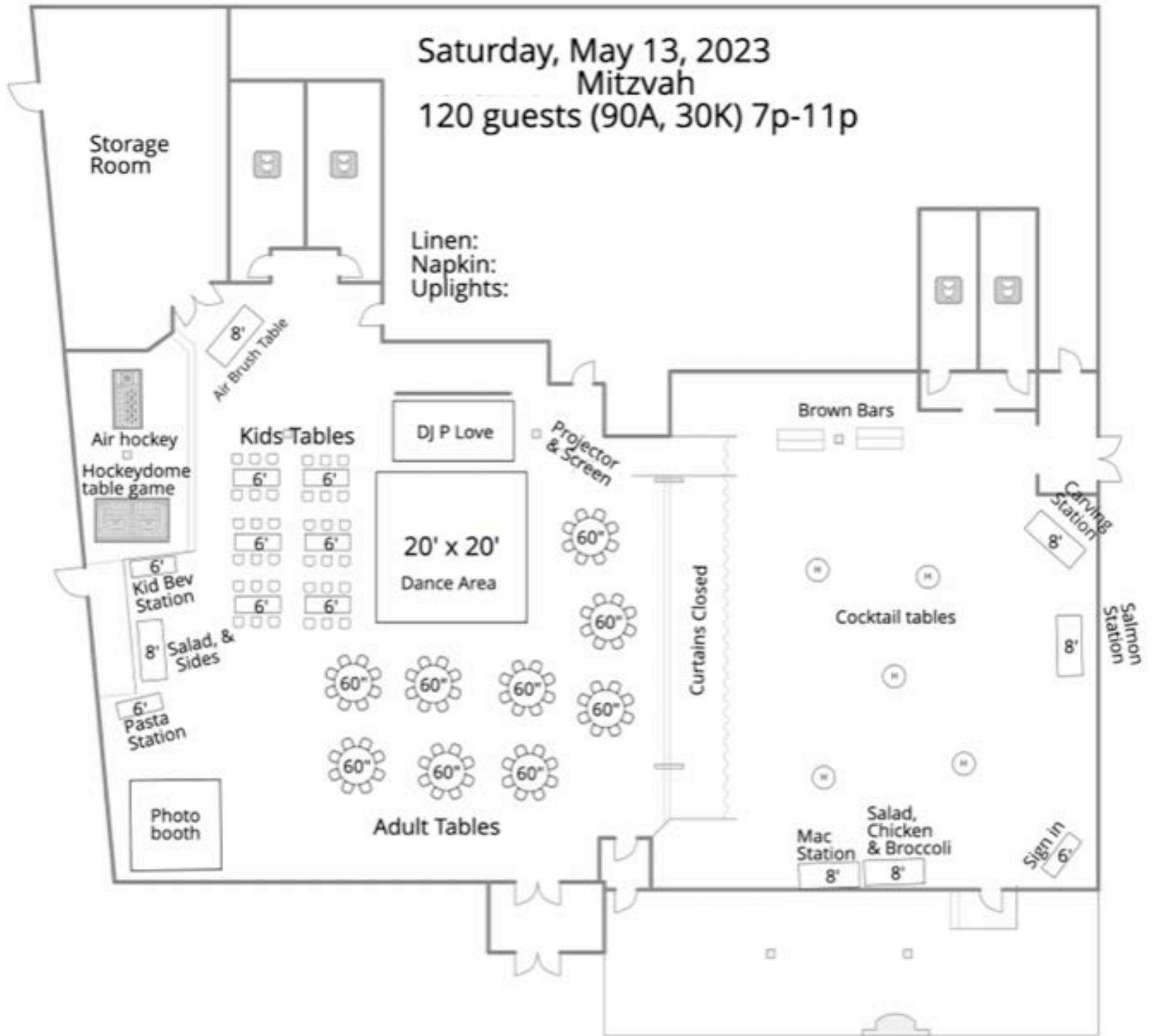

Linen:  
Napkin:  
Uplights:

Curtains Closed

Salmon Station

Mitzvah  
Saturday, Sept 9, 2023  
6:00p-11:30p (150 guests)

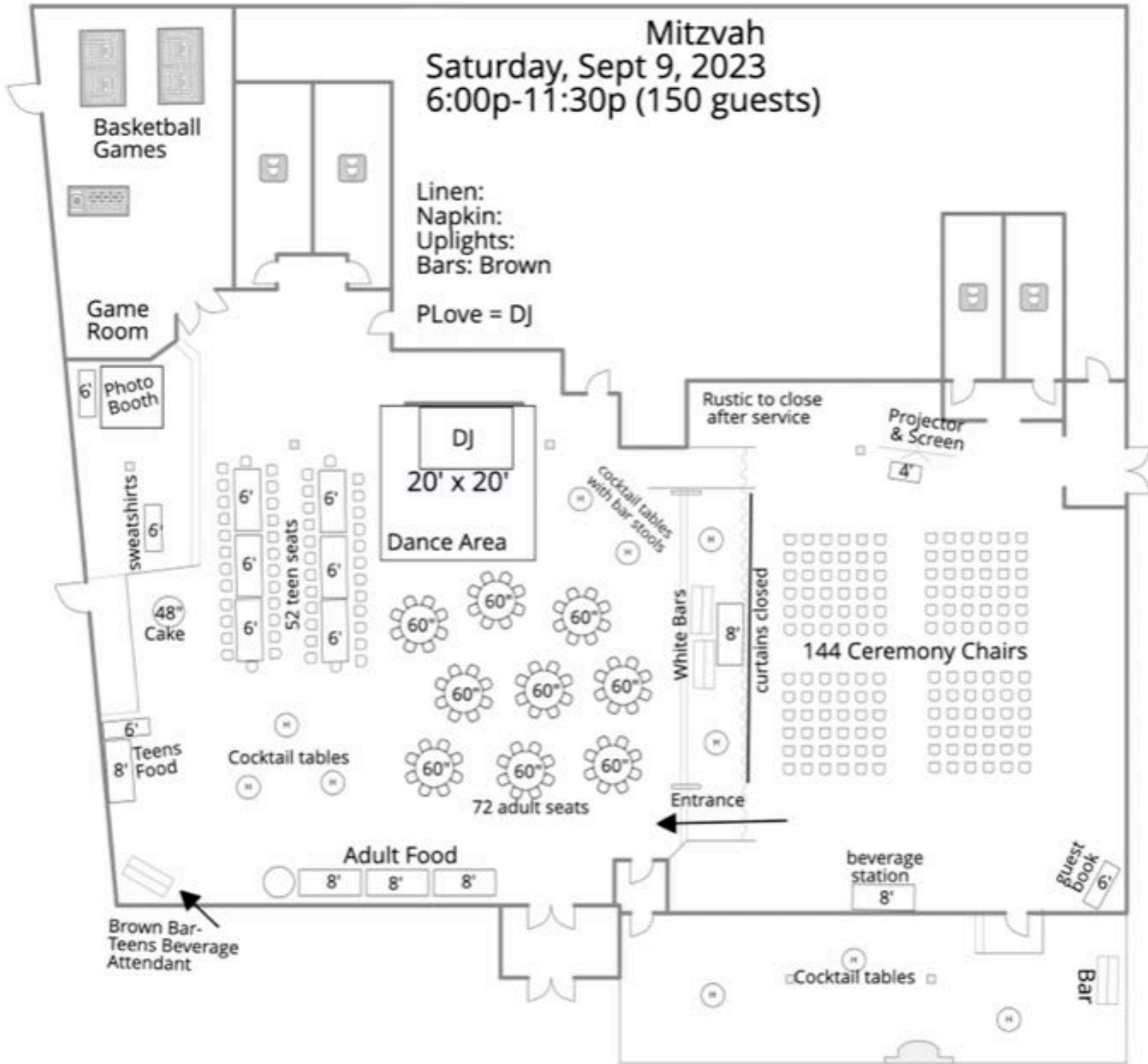

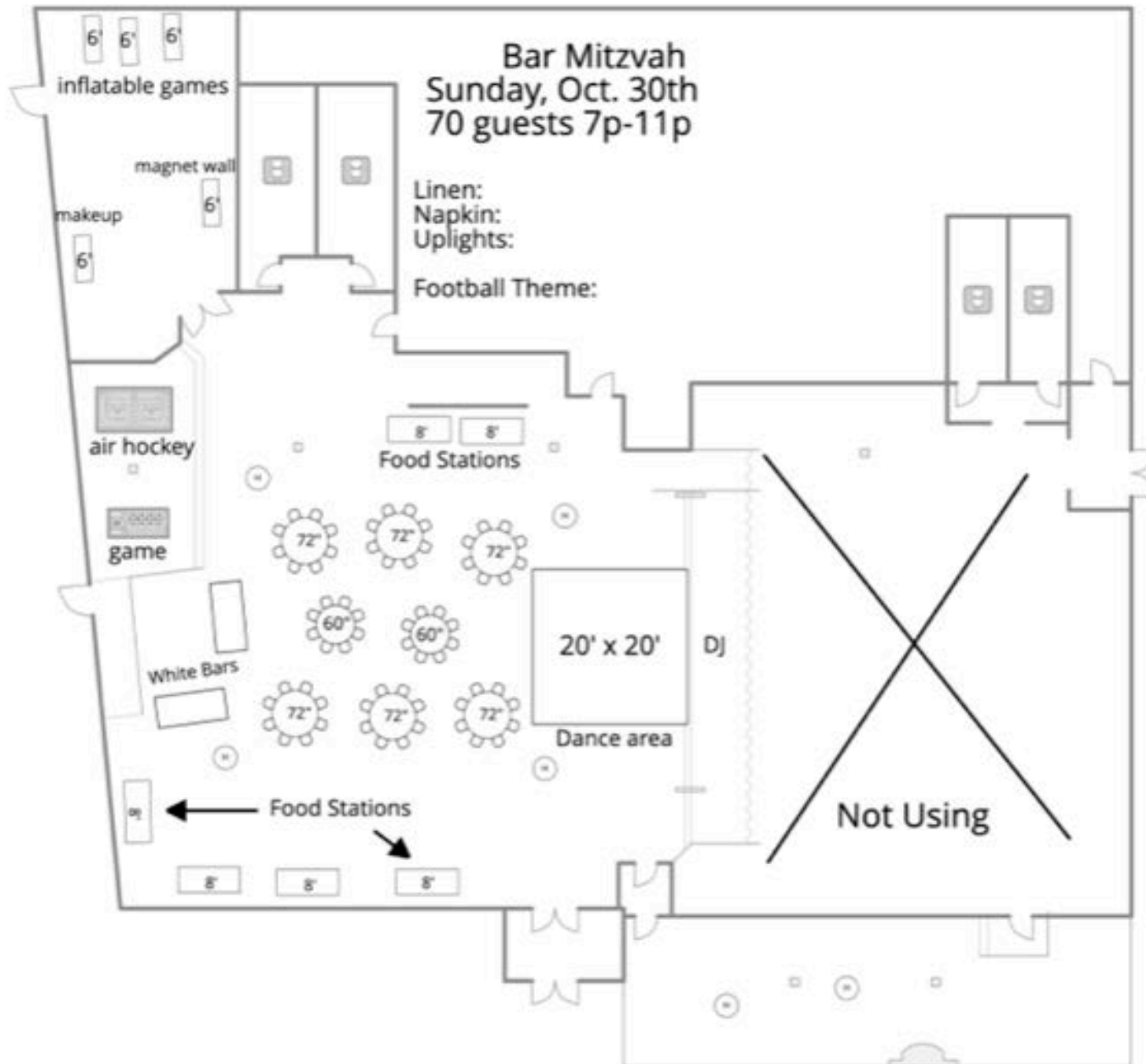

# Bar Mitzvah

Saturday, December 17th  
125 guests 7p-11p

8' 8'  
Storage and Family hangout area

Black Linen, Blue Napkin, Blue Uplights  
(10) 60" rounds with 8 seats for adults  
(6) 8'- with 10 seats for teens

Kids Silverware & Napkin Preset  
Adults Silverware, Napkin, & Water Preset

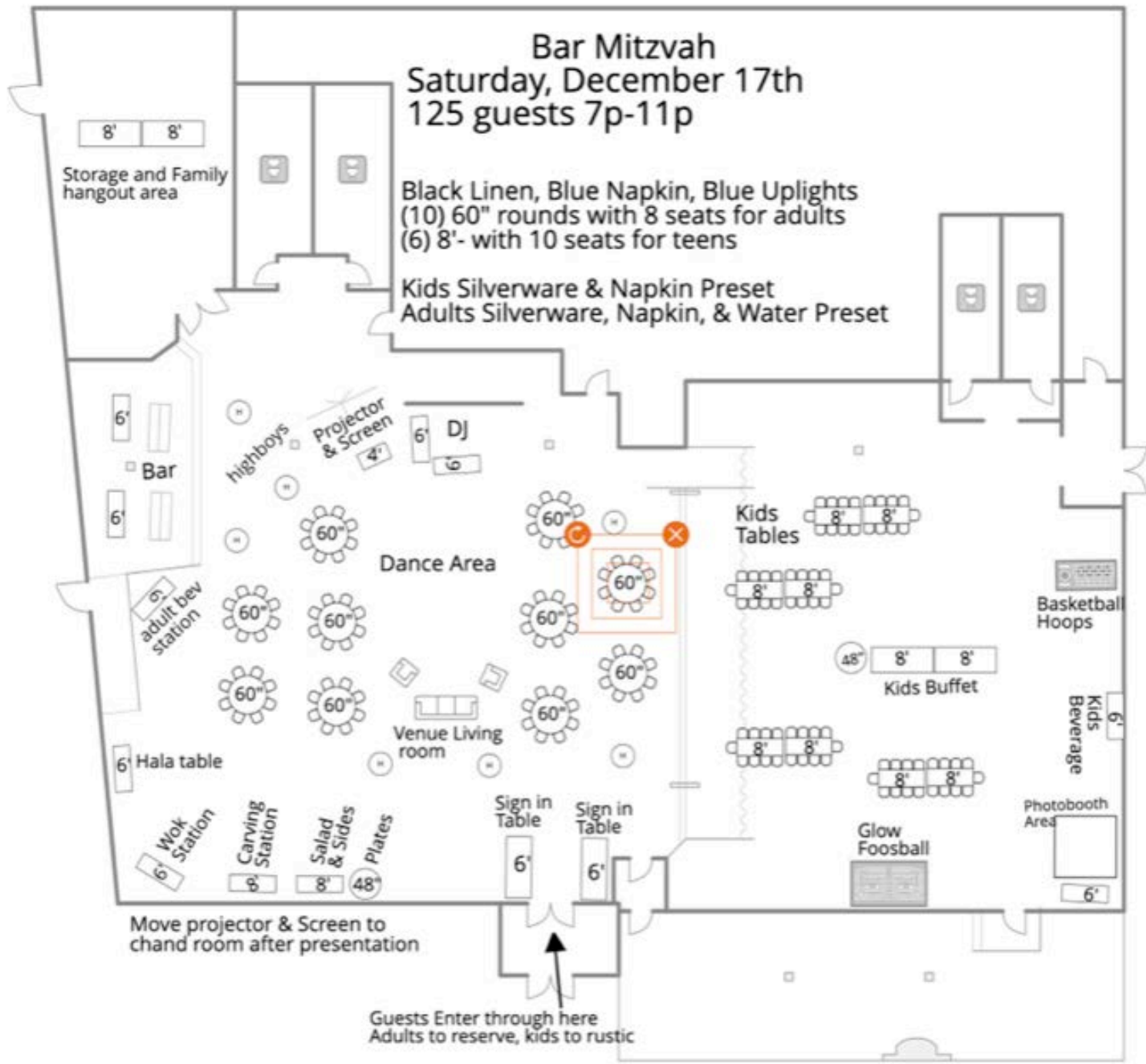

Move projector & Screen to chand room after presentation

Guests Enter through here  
Adults to reserve, kids to rustic

Mitzvah  
 Saturday, May 6th  
 7p-11p (100 guests)

Storage

Linen: Champagne  
 Napkin: Chocolate  
 Uplights: TBD

Preset Water, Napkin, Silverware for adults  
 Rolled up silverware at Table for Teens

Client providing  
 living area and  
 mobile coffee bar



mobile  
 coffee bar

12' x 12'  
 Photo Booth

DJ Roger Haze

24' x 24'  
 Dance Area

airbrush  
 artist  
 8'

cocktail tables  
 with grey stools

cocktail tables

8' 8' 8'  
 Teens Seating Area

60" 60" 60" 60"  
 Adults Seating Area

Brown Bars  
 8'

9' Dessert Station  
 8' Mac & Cheese  
 Pasta Station  
 Pita Station  
 Harvest Salad  
 48' Plates

welcome table  
 6'

venue living room

cocktail tables

7 tables of 8 = 56 adult seats  
 6 tables of 6 + 4 seats = 40 Teen seats

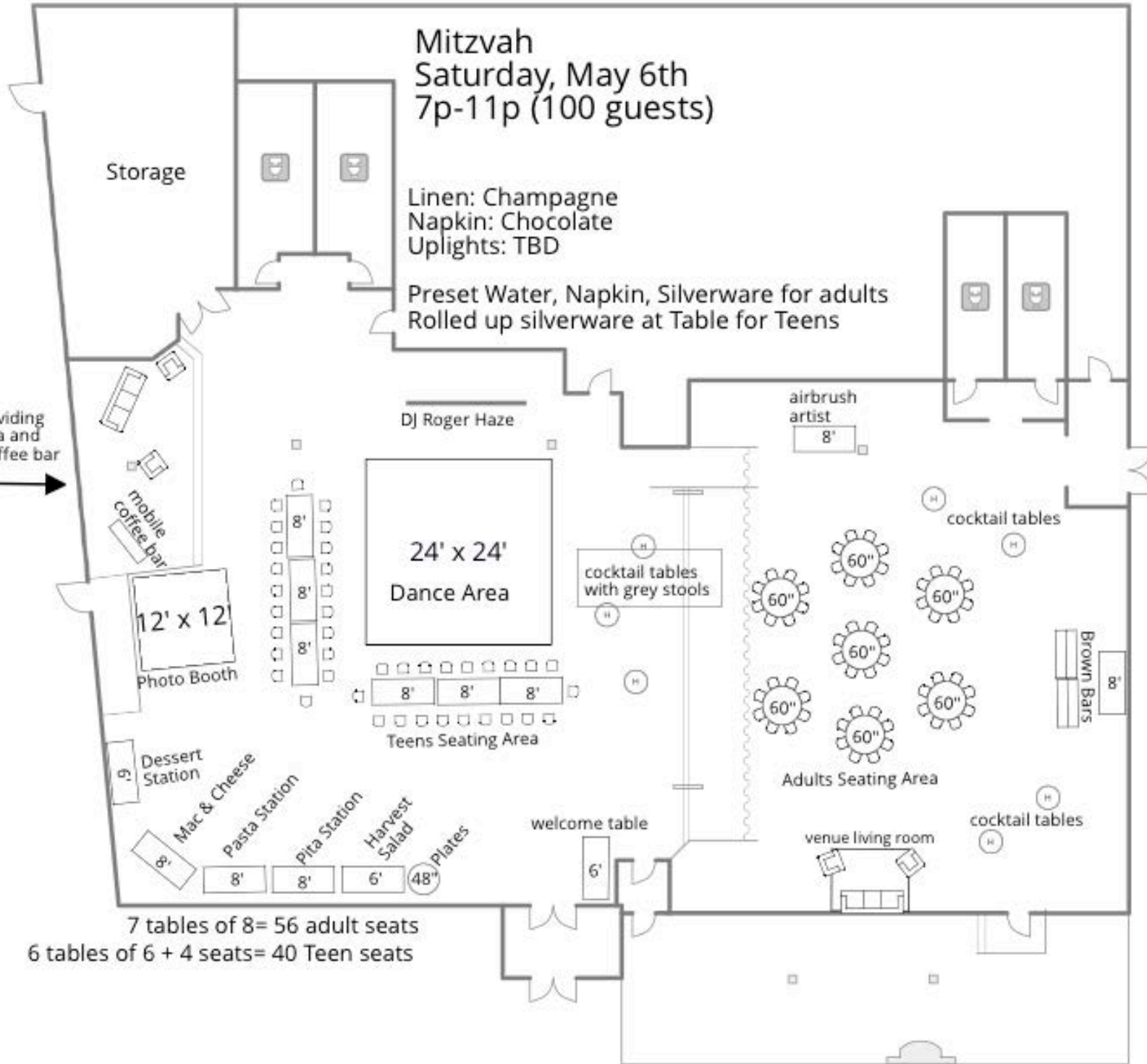



# Bat Mitzvah

Saturday, February 26th  
94 adults, 75 kids (169 total)

Theme: Iridescent, rosegold (lights off in Reserve)  
 - (6) 72" rounds - 12 seats at each table  
 - White linens on tables  
 - White napkin: rolled silverware  
 - Pink Uplights  
 - Possibly using venue silver votives  
 confirm with client on day of

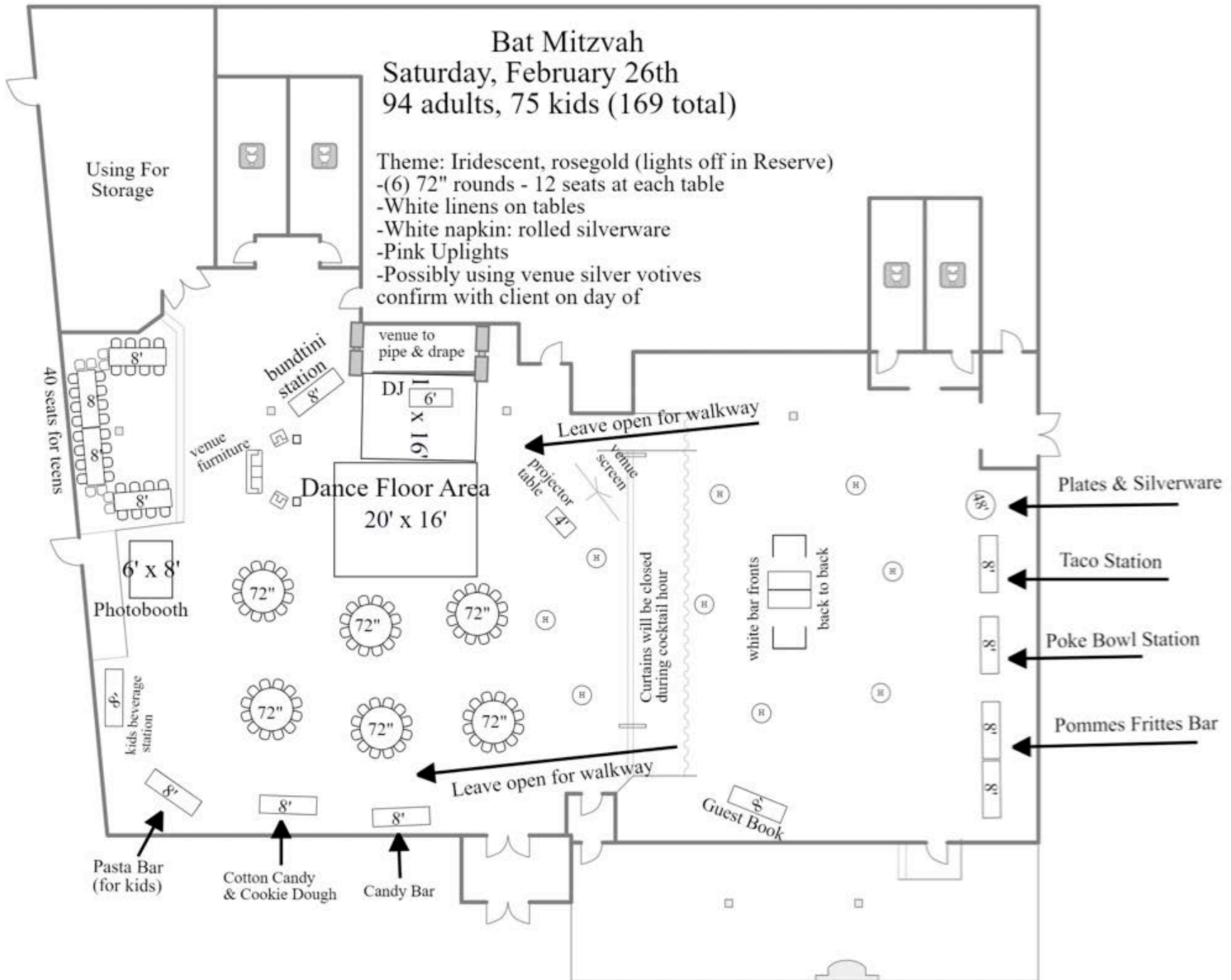

# Bar Mitzvah

Saturday, March 19

90 adults/ 78 kids (168 total)

Theme: Metallic gold, black, white

(5) 72" rounds-10 seats, (6) 60" rounds- 8 seats (adults)

(6) 8'tables- 10 seats each (for kids)

-Pre-set Water & silverware for adults

- Silverware Roll-ups at buffet for Kids

-Black linen on rounds, food tables, teen tables

-White linen on cocktail tables

-White Napkin - Waterfall fold for adults

-Client to provide custom bev naps

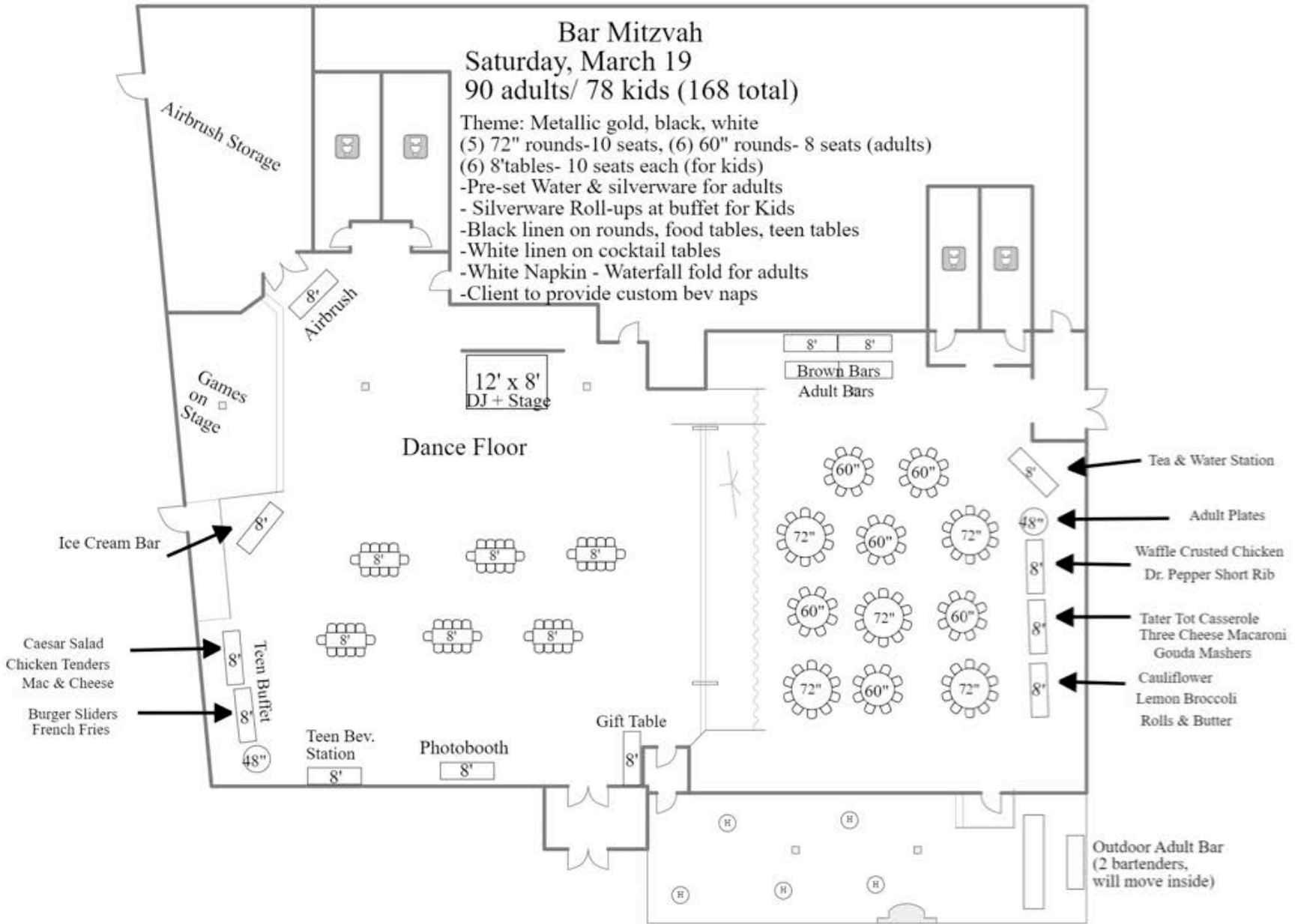

Airbrush Storage

8'  
Airbrush

Games  
on  
Stage

12' x 8'  
DJ + Stage

8' 8'  
Brown Bars  
Adult Bars

Ice Cream Bar

Caesar Salad  
Chicken Tenders  
Mac & Cheese

Burger Sliders  
French Fries

Teen Buffet

Teen Bev.  
Station  
8'

Photobooth  
8'

Gift Table  
8'

Tea & Water Station

Adult Plates

Waffle Crusted Chicken  
Dr. Pepper Short Rib

Tater Tot Casserole  
Three Cheese Macaroni  
Gouda Mashers

Cauliflower  
Lemon Broccoli  
Rolls & Butter

Outdoor Adult Bar  
(2 bartenders,  
will move inside)

Quinceanera  
Sunday, February 19th  
75 guests (6p-10p)

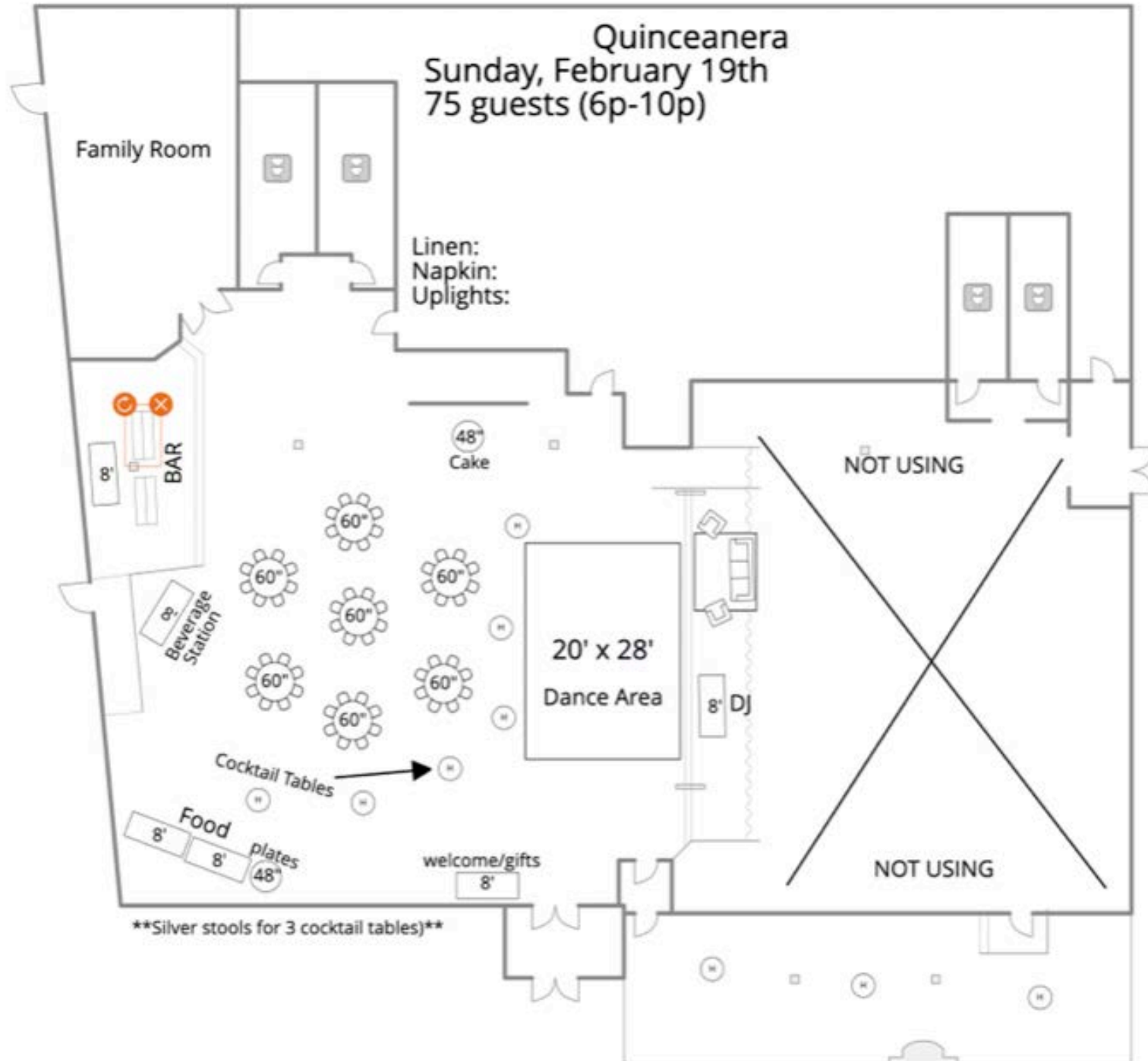

\*\*Silver stools for 3 cocktail tables\*\*

Saturday, April 29th  
Quinceanera  
200 guests 7p-12a

